

Data sheet

Support roller NATR 8 PP X (cylindrical, with axial guidance, cage, seal)

Designation	NATR 8 PP X
Type	cylindrical
D [mm]	24
d [mm]	8
d1 [mm max.]	19
B1 [mm]	15
B [mm]	14
r [mm]	0,3
Dynamic load Crw[N]	5500
Static load C0rw[N]	6400
Speed limit [min-1]	15000
Speed limit [min-1]	16000

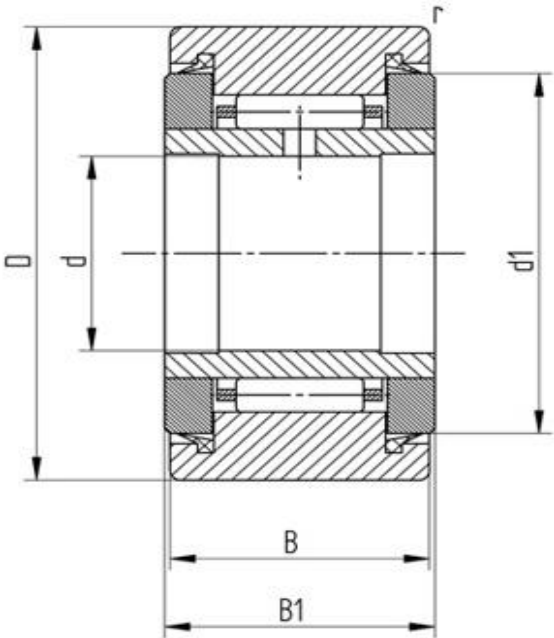

Every specification has been edited and verified carefully. STI Bearings GmbH assumes no liability for potential errors or incompleteness. Technical modifications are subject of changes.

© 2020 by STI Bearings GmbH  
Reproduction, even excerpts, only with our approval.